



26-A/2, 1st Floor, Palm Road, Civil Lines, Nagpur-440 001
Ph : 0712-6627331 (Five Lines) E-mail : info@amrtarealty.com
Web Site : www.amrtarealty.com; amrta.biz

Changes/alteration affecting the overall design concept and outlook of the scheme are strictly NOT PERMITTED during or after completion of the scheme.
The brochure is intended only to convey the essential design and technical features of the scheme and shall not be construed to form part of the legal document.

Swapnil_9823033083



joy of high life



amrta's
Mangal Smruti

We have always been dreaming about a place called the paradise where existence is meaningful and the same time positive too. It's a place where you could experience a amalgamation of Peace, Prosperity and Luxury. amrta's Mangal Smruti is such a place where you would find a perfect blend of Luxury & Lifestyle with World class amenities. amrta's Mangal Smruti is a 6 Storeyed Residential Tower of 3 BHK spacious flats, with all the comforts of an elevated lifestyle. A place where you'll find world class amenities that would make your life easy and contended.



amrta's
Mangal Smruti

joy of high life

joy of high life



amrta's
Mangal Smruti



A grand and bold statement is made and the tone and spaces at for amrta's Mangal Smruti, right at the Entrance. Embellished with Luxury, Impressive in its spread and rise. Muted in its decor, the gate and Entrance to amrta's Mangal Smruti attracts a second look effortlessly of the passerby. Success speak is understood by those who have tasted it and we at a Amrta Realty know it and speak it fluently. That's why each apartment is allocated with ample parking spaces for residents to enable parking of 3 cars for one house and there is valet parking available for the residents who can get out and get in to their cars right at the entrance of their lobby.



STEP INTO THE
PARADISE





PAMPER YOURSELF

Home Theatre within building
Spend those boring Sunday's with your
Favourite Movie at your own Building
with your close-ones.



REJUVINATE THE
RHYTHM OF LIFE





FREE YOURSELF

High up on the terrace, the jogging track gives you a reason to exercise.



GIVE WINGS TO
YOURSELF





BREATHE YOURSELF

Souna and Steam Bath with
Jacuzzi for your self to breathe



WATER THERAPY FOR
REJUVENATION





BUILD YOURSELF

Rejuvenate and relax yourself
after a hard day's work in your
Personalized Gymnasium.



NOTCHE UP YOUR
HEALTH





amrta's

Mangal Smruti

A smallest of things plays an important role in life when it comes to Home. Each smaller piece assembled together makes a home of your choice, like internal, external amenities also reflects the extent of luxury and lifestyle. Here we have designed amenities meticulously which would reflect the perfect picture of your own dream home and at the same time provide you the space to explore and discover new dimensions in life. At amrta's Mangal Smruti you would be spoiled for choices. The spacious, 3 BHK are luxuriously and meticulously designed flats with state-of-the-art amenities, thereby ensuring you, living a comfort and peaceful life and at the same time elevating you from your current lifestyle.



amrta's
Mangal Smruti

At amrta's Mangal Smruti, true luxury is a sum of many such remarkable elements stitched together, in Grand Style. just for you. In tune with nature, Indulge in a healthy lifestyle where you open your eyes to mornings of fresh air, with a walk with nature and end your day with the comfort of family and friends. Expend your intelligence to upholding your profession; live a care free, relaxed life of comfort and ease that could only come when you're aware that your loved ones are secure and well protected. To experience this dream life in reality you have to be here with us to experience the difference. Every apartment is a work of architectural excellence, designed to capture and preserve the glorious natural ambience of the surroundings.



Space should be settled in such a way that,
it safe guards your privacy yet exudes hospitality.



amrta's
Mangal Smruti



Typical Floor Plan

1st, 3rd & 5th
2550 sq.ft

2nd, 4th & 6th
2555 sq.ft

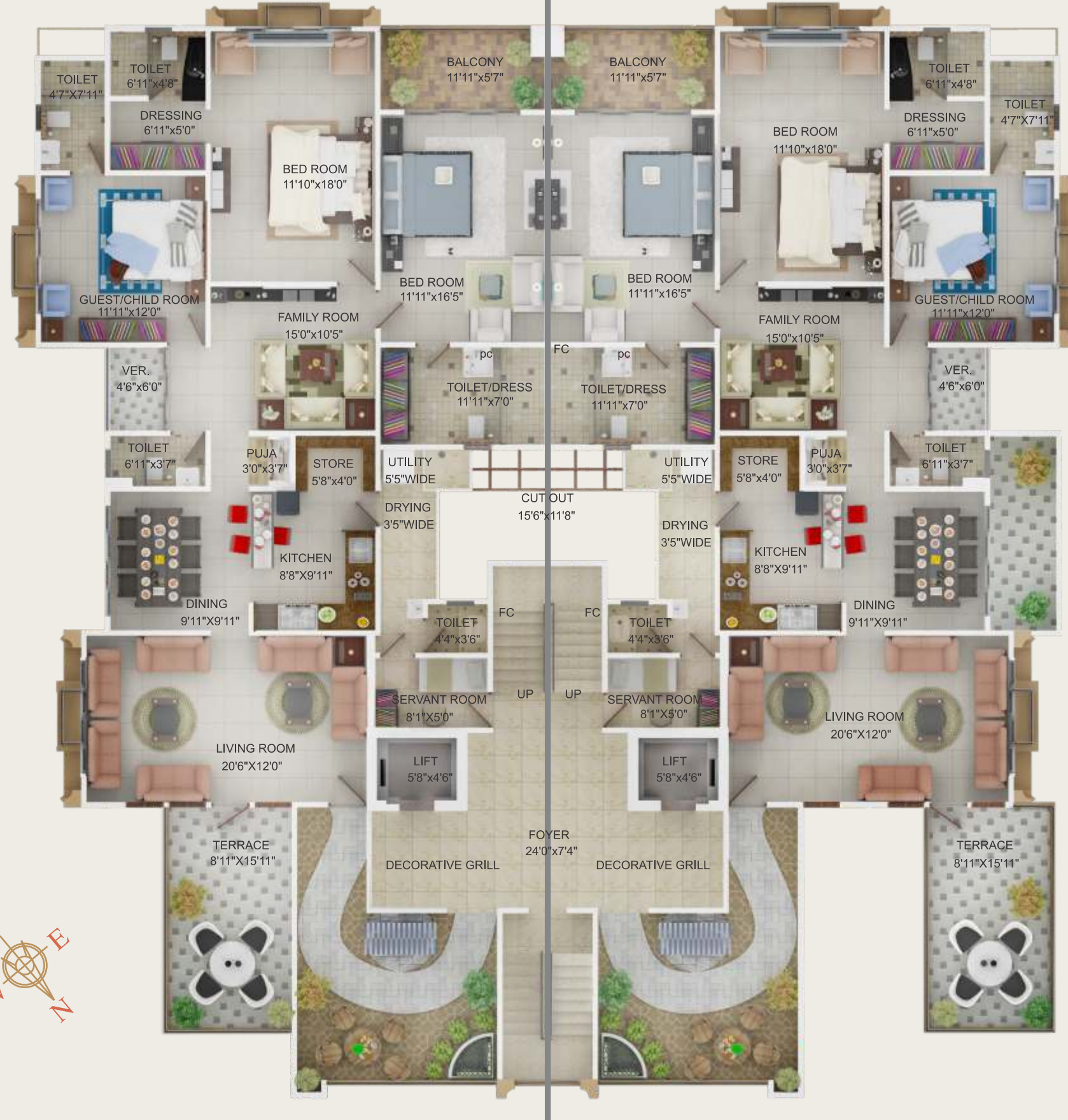

amrta's
Mangal Smruti



Basement Plan



Ground Floor Plan



Terrace Plan



Luxury Becomes
Necessity



DETAIL MAKES ALL THE DIFFERENCE

Green Zones : Senior Citizen Seating Area

Safety & Security : Fire Fighting System
3 Steps Security System Round The Clock
Security Guard Room
Intercom Facility
Digital Security System (VDP)hh

Health & Fitness : Jogging Track
Health Club
Jacuzzi Bath
Sauna Bath
Steam Bath

Entertainment : Home-Theater

Value Addition : Decorative Main Gate with Compound Wall
Impressive Lobby
Basement And Ground Parking
Separate Visitor's Parking
Dedicated DTH / Cable Connectivity
Every Room with Nitch Balcony
Every Flat with Servant Room & Toilet
Generator Power Back-up for Common Areas
Lifts with V3F Drives
Rain Water Harvesting System
Car Washing Area with Pump
Sanitation Facilities For Drivers And Servants
Gas Bank
Solar Heating for Hot Water
Common Society Office



Legal Notes

Stamp duty, registration charges, legal documentation charges, society charges, water/electricity meter charges including cable and sub-station cost shall be borne by the purchaser. Service tax, VAT & LBT or any other additional charges, taxes, cess or duties levied by the Government/Local authorities during or after completion of the project will be borne by the purchaser.

In the interest of the continual developments in design and quality of construction, the developer saves all rights to make any changes in the scheme, including technical specification & designs.



SPECIFICATION

Structure :

Earthquake Resistance R.C.C Framed Structure

Walls :

9” thick External Walls and 6” thick Internal Walls

Treatment :

Anti-Termite Treatment and Water-Proofing in foundation Water-Proofing for Toilets and Bath Blocks

Flooring:

Vitrified Tiles to all over Flat & Wooden Floor in Master Bedroom

Balconies and Terraces shall have Ceramic Tiles Flooring

Designer Coloured Anti-skid Tiles for Toilets

Kitchen :

Granite Platform Top with Stainless Steel Sink

Wall Cladding with Vitrified Tiles above the Platform

Provision for Outlet Pipe for Chimney

Hot and Cold mixing unit

Doors :

Teak Wood Main Entrance Door along with Teak Wood Frames

Wooden Doors for Internal Doors

Windows :

Aluminum Powder Coated/Anodized Windows

with Light Tinted Glass

Toilets :

Sanitary Ware of Hindware or equivalent

Fittings of Jaguar or equivalent

Designer Coloured Glazed-Dado Tiles for Wall Cladding

U-PVC piping for Water Supply as per IS

PVC piping for Rain Water Piping as per IS

Electrification :

Modular Switches of Legrand or Equivalent

Concealed copper wiring with 4½ electrical points in each room

Main Distribution box, with Earth Leakage Circuit & Miniatures Circuit Breakers

TV and AC Points in all Rooms

Microwave, Refrigerator points in the Kitchen

Geyser Point in all Bathrooms along with Plug Points for Utility Area

Inverter Back-up point

Utility Area :

Arrangement of Washing Machine along with Water In /

Outlet with Electrical point

Wall Finish :

Smooth Putty Finish internally and silicon based paint externally



| DRIVING FORCE | ARCHITECTS | STRUCTURAL DESIGNER | LEGAL ADVISOR | FINANCIAL ADVISOR | MARKETING ADVISOR |
|------------------------------|--------------------------------------|---|-------------------------------|---|--------------------------------------|
| A.M. Quazi +91-9422109998 | Modi Associates Ahemdabad | P.T Mase and Associates +91-9822220919 | A.S. Lulay +91-712-2293781 | Vivek Tiwari +91-9373107896 | Roshan Real Estate +91-9822200500 |
| Anil Kilor +91-9373104125 | Kishore Mehata +91-9371431000 | | | Dhoot Bagadia & Company +91-9822942993 | |
| | Roshani Associates +91-9823087141 | | | Amit Rajkotiya (CS) +91-9823122521 | |

AN ADDRESS AS DESIRABLE
AS THE HOME

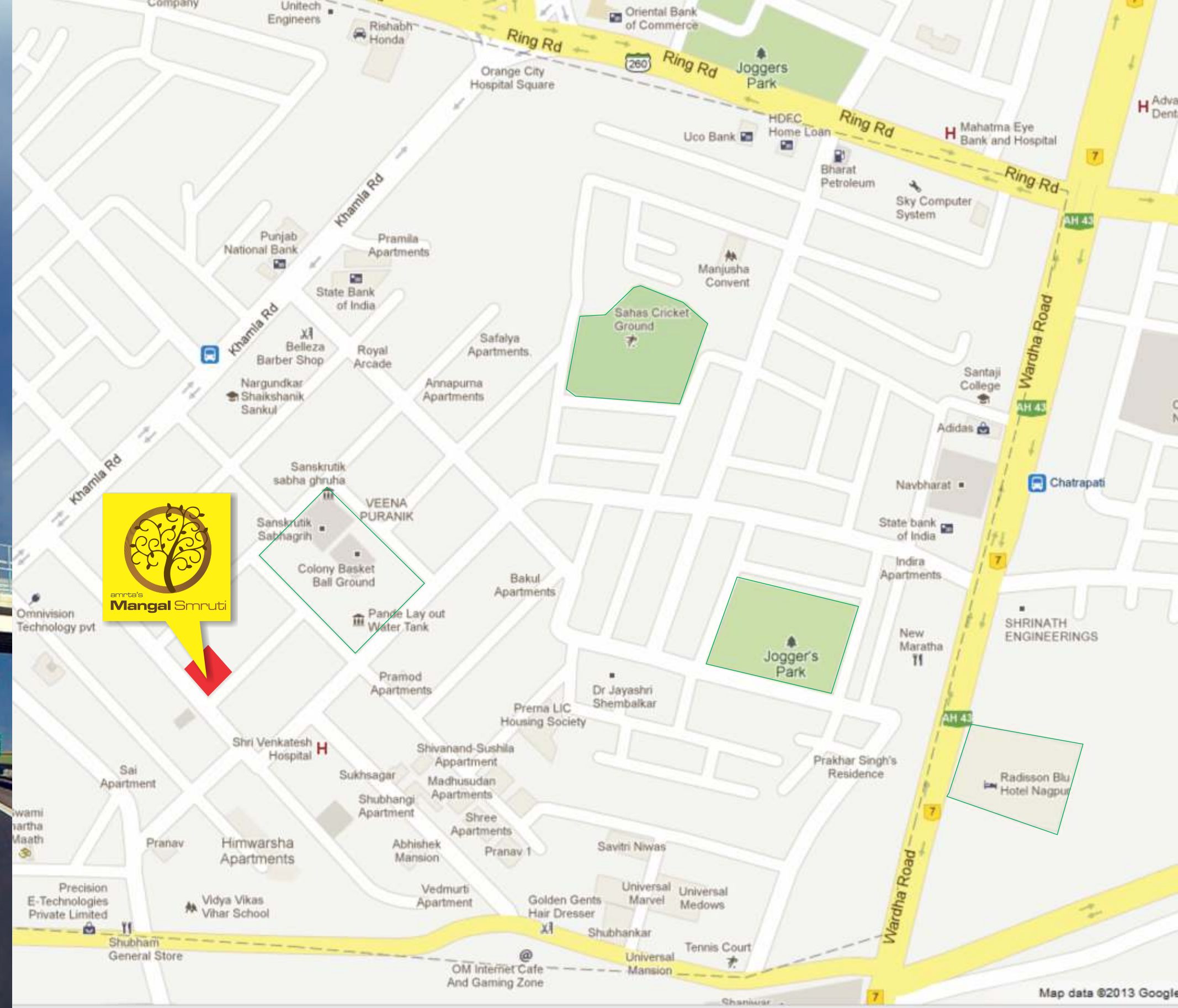

SITE ADDRESS
PLOT NO 145, PANDE LAY-OUT, KHAMLA NAGPUR-440 025
by





LIVING ROOM CUM TERRACE



KITCHEN





ROOF TOP